

TECHNICAL AND ORDERING DATA

Standard Specifications

- Voltage: 120(220 available, consult factory)
- Ballast: Electronic high power factor
- 2-Lamp and 4-Lamp versions available (only 2 lamps operate at a time)
- On 4-lamp version, you have a choice of 2 available Kelvin temps
- Mounting: Mounting holes (four) provided for mounting to mechanically sound surface
- Recessed mounting kit offered as an available option
- ETL Listed for damp locations

* For custom shapes and sizes, please consult factory.

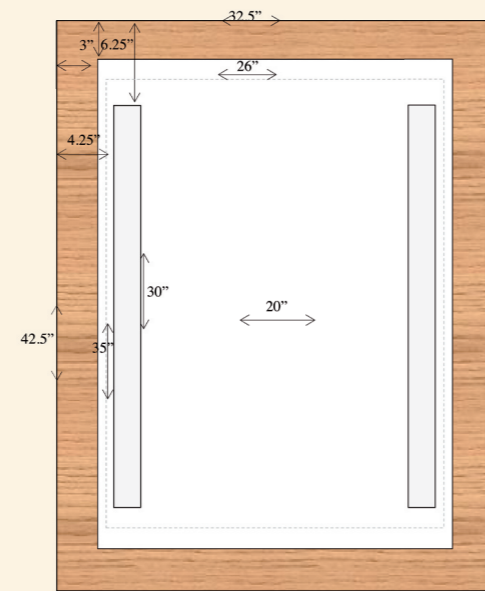

SPECIFICATIONS (SCALE 1/8" = 1")

- O/S DIMENSIONS -32.5" WIDE X 42.5" HEIGHT
- ALUMINIUM BOX- 26W" X 35H"
- LIGHT STRIP STARTS 4.25" FROM MIRROR EDGE
- SAND BLASTED WINDOW SECTION-2"W X30"H
- BULB TO BE F21T5 X 2 (34")
- ELECTRONIC BALLAST
- RE-LAMPING BY REMOVING GLASS
- PLEASE ALLOW SPACE AT THE SIDES OF MIRROR FOR RELAMPING

Please note AAMSCO reserves the right to vary placement of inserts and mounting features to accommodate manufacturing tolerances. Specification outlined are subject to a +/- 1/8" variance

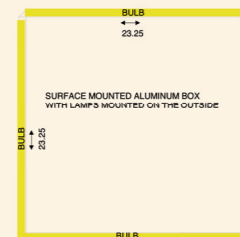
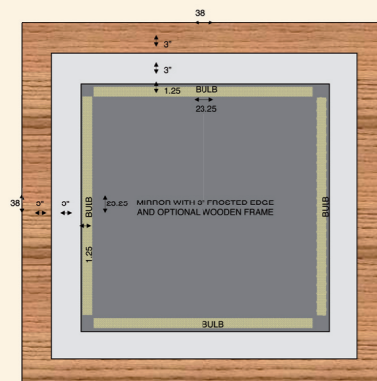

MIRROR-LUX[®] Framed Mirrors

Patented bulbs used to produce no end shadows or scalloping.

Classically elegant with a sleek sensuality of the modern, the Mirror-Lux[®] framed editions transforms your space into a timeless combination of contemporary and traditional good looks.

You can frame the weightless radiance created by the diffused, indirect lighting of the Mirror-Lux[®] with any of our beautiful selections of weathered bronze, coppers, golds or elegant woods. You also have the option of choosing any frame available on the market, it's easy to frame the Mirror-Lux[®] any way you like.

